

# EXHIBIT 2

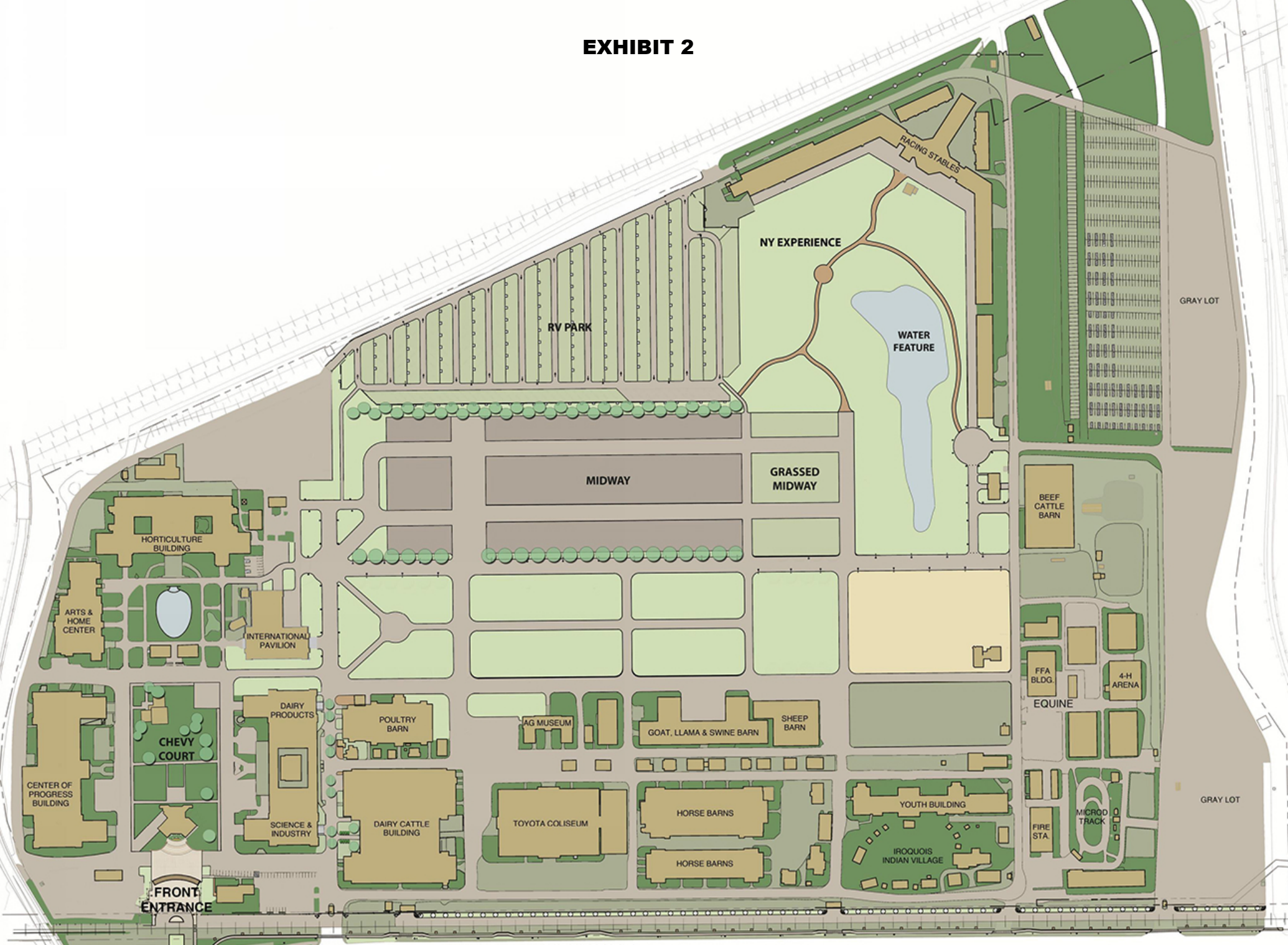

# The Art & Home Center

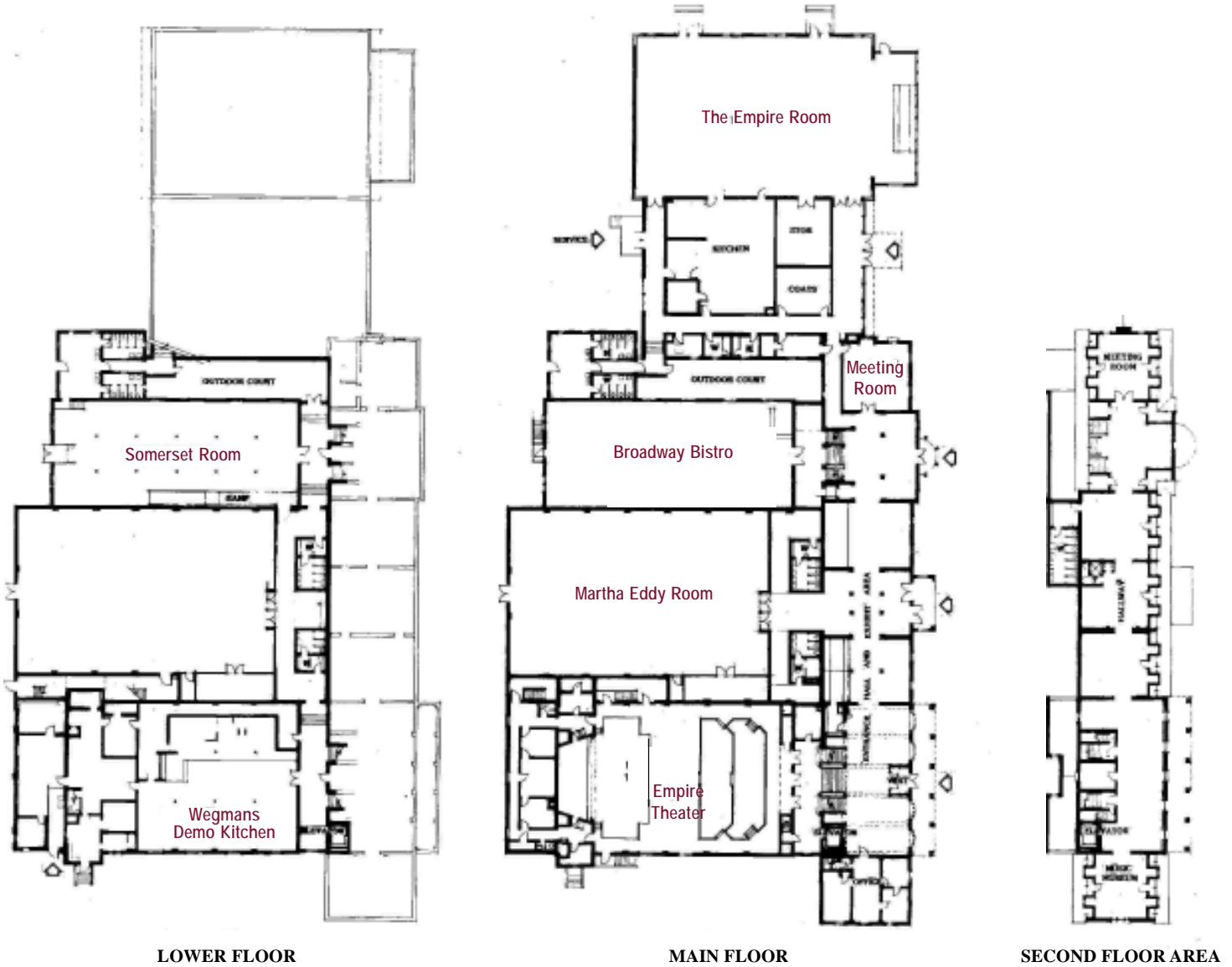

## Somerset Room

- Up to 175 guests Theater-style
- Up to 85 guests Meeting/Classroom-style
- 1,770 square feet – 30' x 59'

## Broadway Bistro

- Up to 225 guests Theater-style
- Up to 130 guests Meeting/Classroom-style
- 3,420 square feet – 38' x 90'

## Art & Home Center Meeting Room

- Up to 50 guests Theater-style
- Up to 25 guests Meeting/Classroom-style
- 540 square feet – 24' x 22.5'

## Wegmans Demonstration Kitchen

- Up to 200 guests Theater-style
- Up to 100 guests Meeting/Classroom-style
- Seating area: 1,740 square feet – 29.5' x 59'
- Demo area: 416 square feet – 16' x 26'

## Martha Eddy Room

- Up to 350 guests Theater-style
- Up to 225 guests Meeting/Classroom-style
- 5,265 square feet – 58.5' x 90'

## Second Floor Hallway Area

- 3,660 square feet
- Elevator access

## Main Floor Hallway Area

- 3,520 square feet
- Three entrances

## Empire Theater

- Up to 250 guests Theater-style
- Up to 180 guests Meeting/Classroom-style
- Stage area: 682 square feet – 22' x 31'
- Seating area (3 tiers): 2,491 sq. ft. – 53' x 47'

## Entire Facility

- Up to 1,250 guests Theater-style
- Up to 745 guests Meeting/Classroom-style
- 19,984 square feet

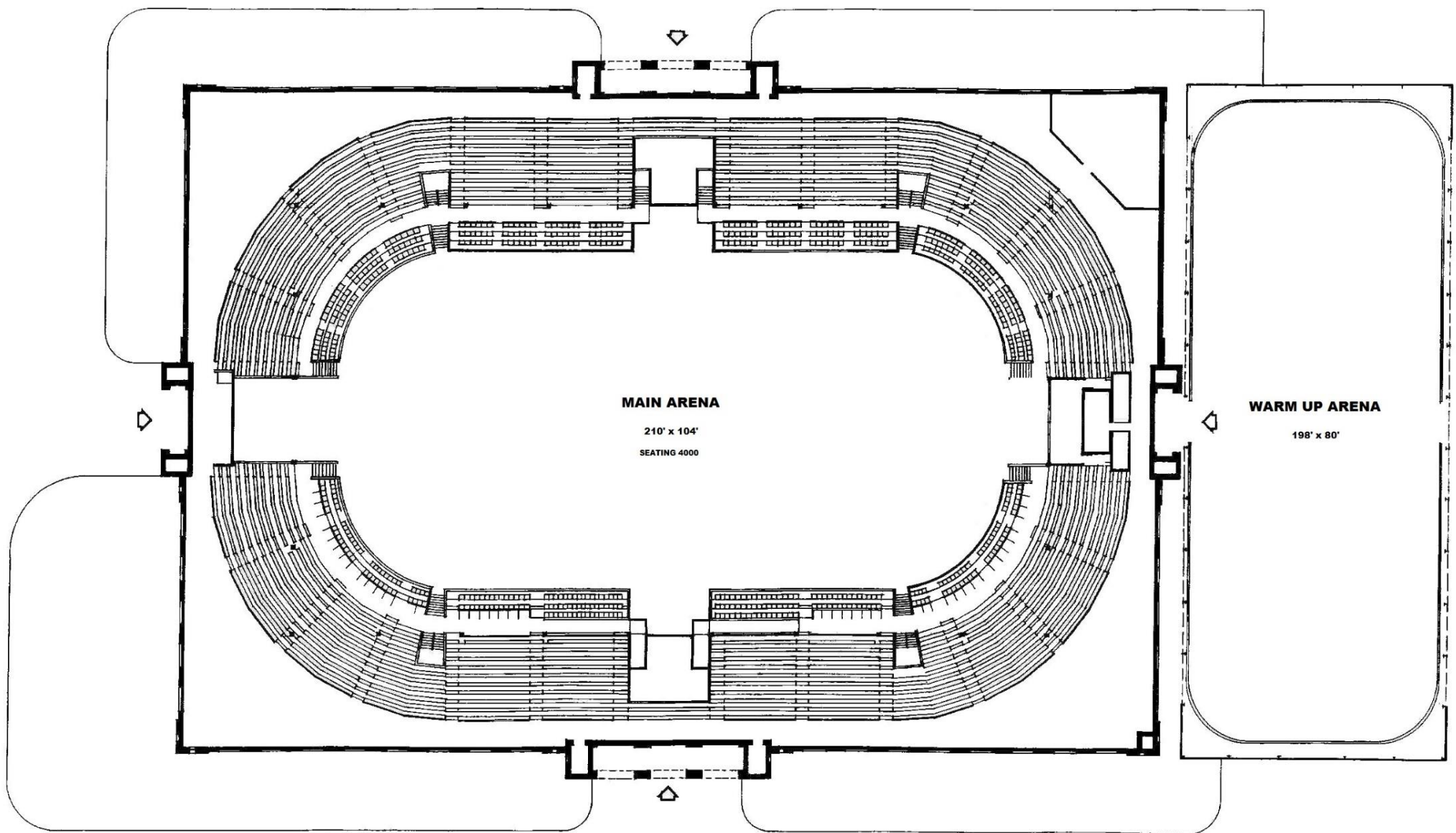

**MAIN ARENA**  
210' x 104'  
SEATING 4000

**WARM UP ARENA**  
198' x 80'

**COLISEUM**



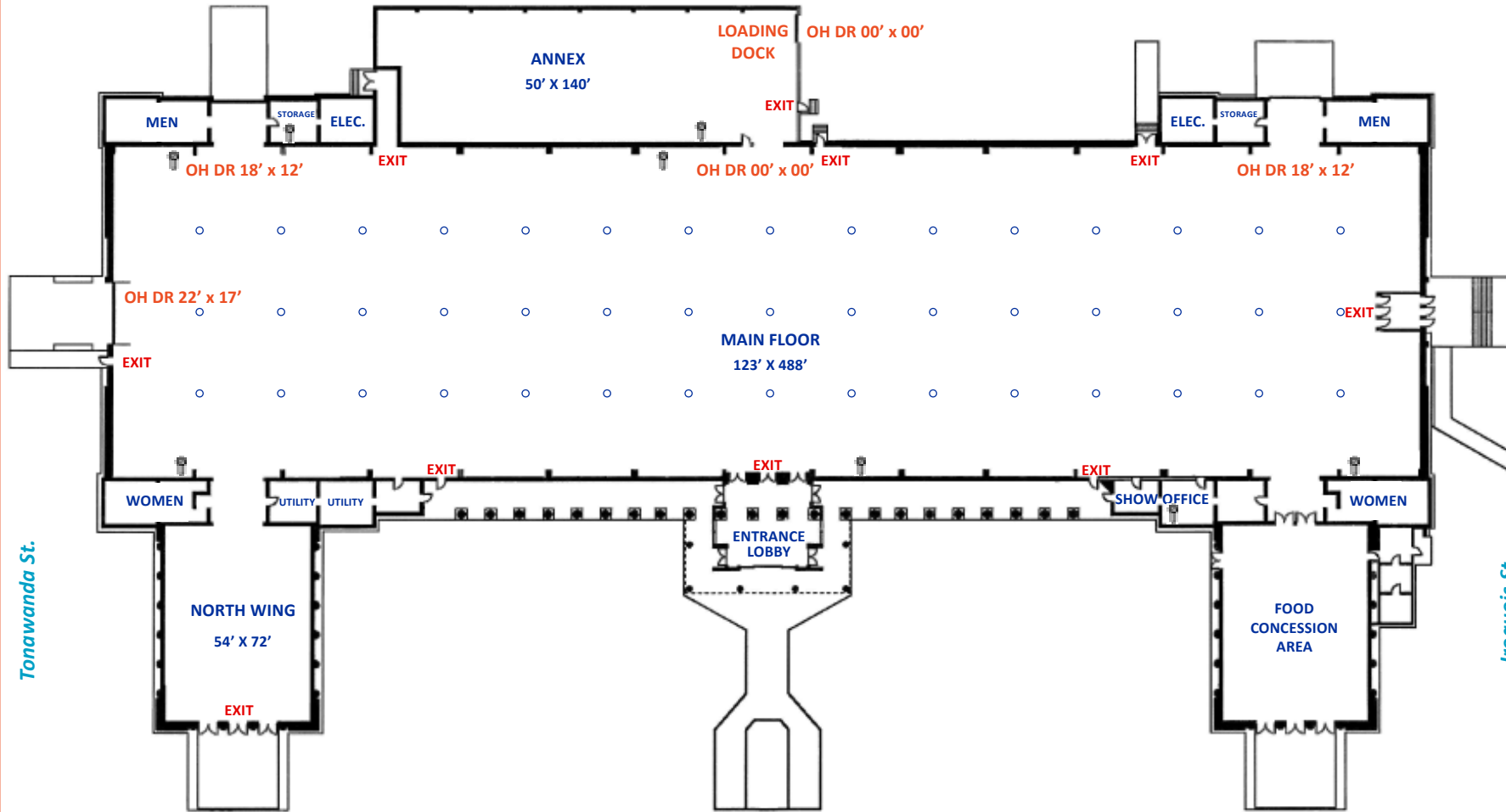

# CENTER of PROGRESS

• 60,000 Square Feet of Exhibit Space •

## FEATURES:

- Show Office with private restroom and phone line – 315.487.7711 x1252 (local calls only)
- Food Concession Area
- Restrooms (4 Public)
- Handicapped Accessibility
- Two-way radio to communicate with Events Staff

## ACCESS:

- 1 Loading Dock Overhead Door – 00' x 00'
- 1 Overhead Door – 22' x 17'
- 2 Overhead Doors – 18' x 12'

## ELECTRICAL:

- 110/208

## LIGHTING/STAGING:

- 400W High Output Lighting Fixtures

## FLOORING:

- Concrete

## AUDIO:

- House Paging System
- 8 Permanent Microphone Locations – 

○ = ELECTRICAL BOXES

Tonawanda St.

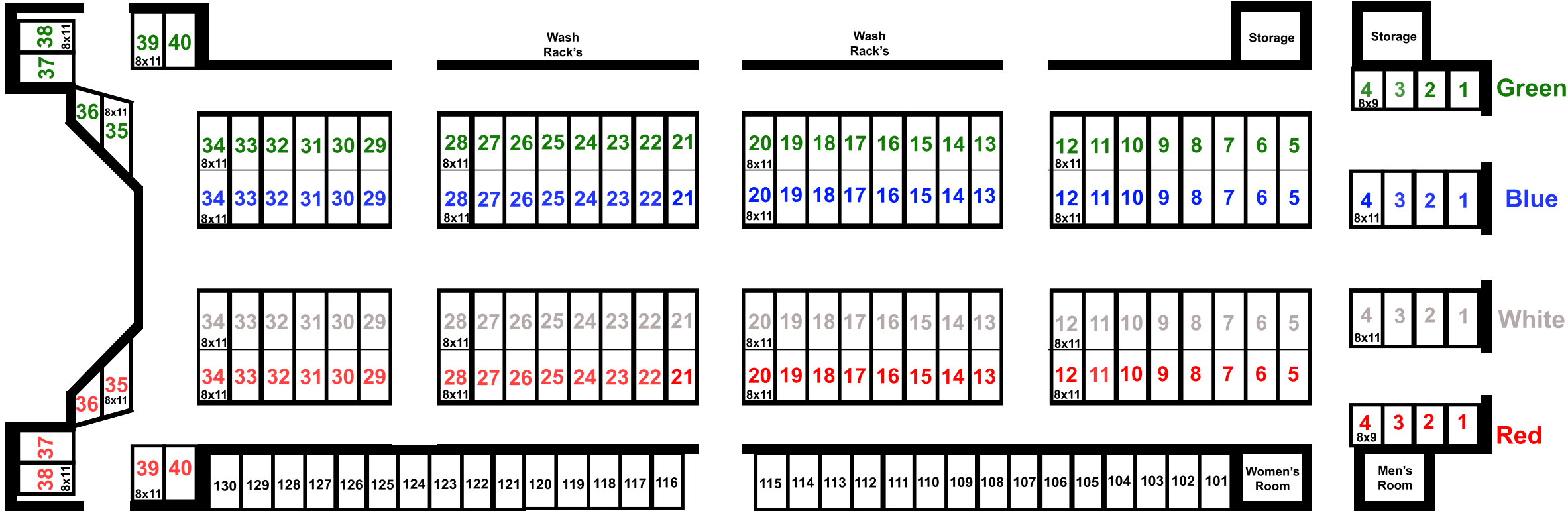

DVM Barn

Main Horse Barn

# EXHIBIT CENTER

• 92,000 Square Feet of Exhibit Space •

## FEATURES:

- Show Office with private restrooms, sink area, and phone line – 315.487.7711 x1310 (local calls only)
- 3 Regular Offices
- Food Concession Area
- Restrooms (4 Public, 3 Private w/ Showers)
- Laundry Facilities
- Handicapped Accessibility
- Two-way radio to communicate with Events Staff

## ACCESS:

- 1 Loading Dock with Overhead Door – 12' x 14'
- 1 Overhead Door – 14' x 14'
- 6 Overhead Doors – 10' x 10'

## ELECTRICAL:

- Non-Commercial Electric

## LIGHTING/STAGING:

- 400W High Output Lighting Fixtures

## FLOORING:

- Concrete

## AUDIO:

- House Paging System
- 10 Permanent Microphone Locations – 

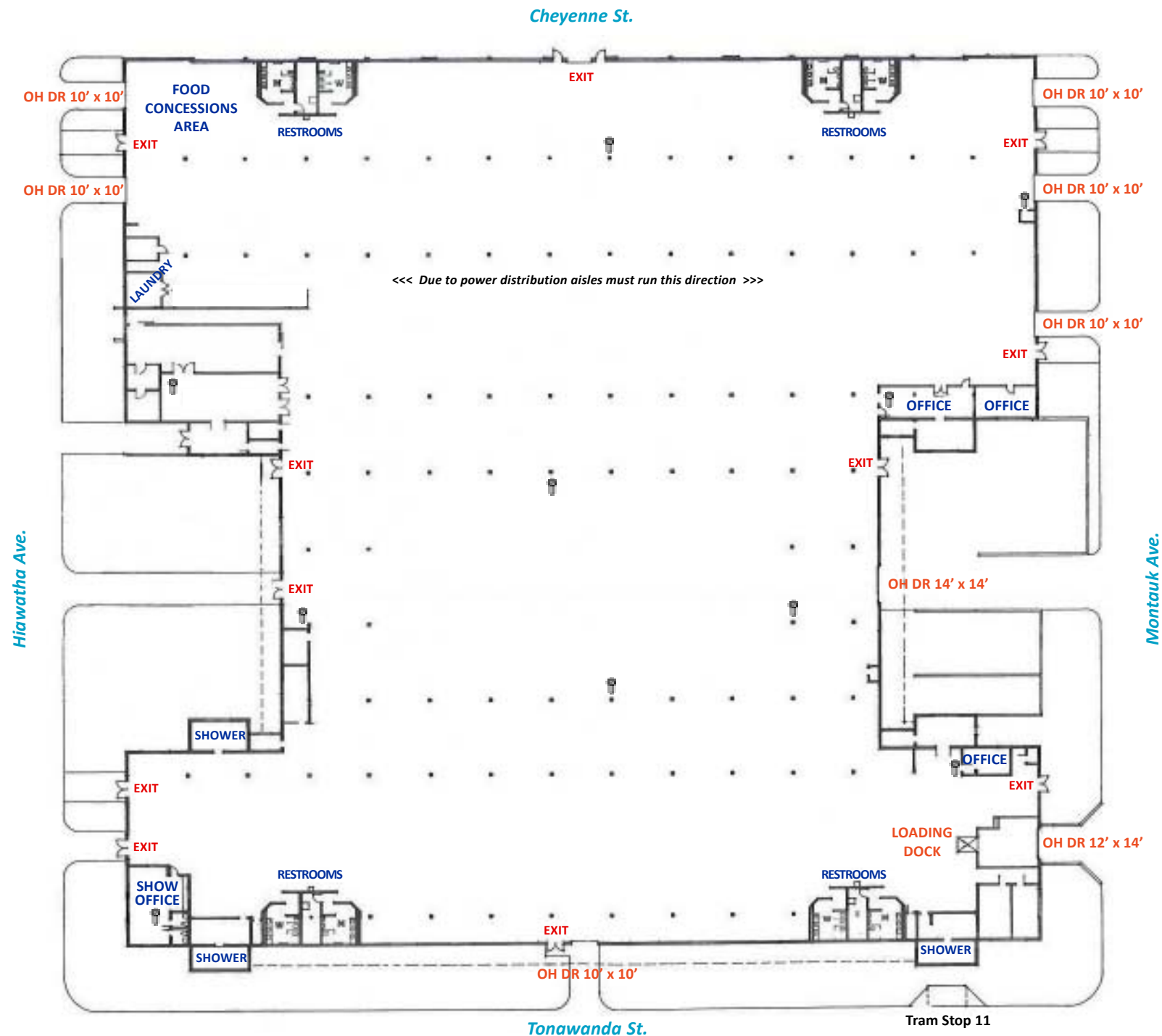

■ = PILLARS

# HORTICULTURE BUILDING

• 52,400 Square Feet of Exhibit Space •

## FEATURES:

- 2 Show Offices with phone line  
– 315.487.7711 x1275 (*local calls only*)
- Restaurant
- Restrooms (2 Public)
- Handicapped Accessibility

## ACCESS:

- 1 Overhead Door – 16' x 17.5'
- 1 Overhead Door – 16' x 16.5'

## ELECTRICAL:

- Non-Commercial Electric

## LIGHTING/STAGING:

- 400W High Output Lighting Fixtures

## FLOORING:

- Concrete

## AUDIO:

- House Paging System
- 3 Permanent Microphone Locations – 

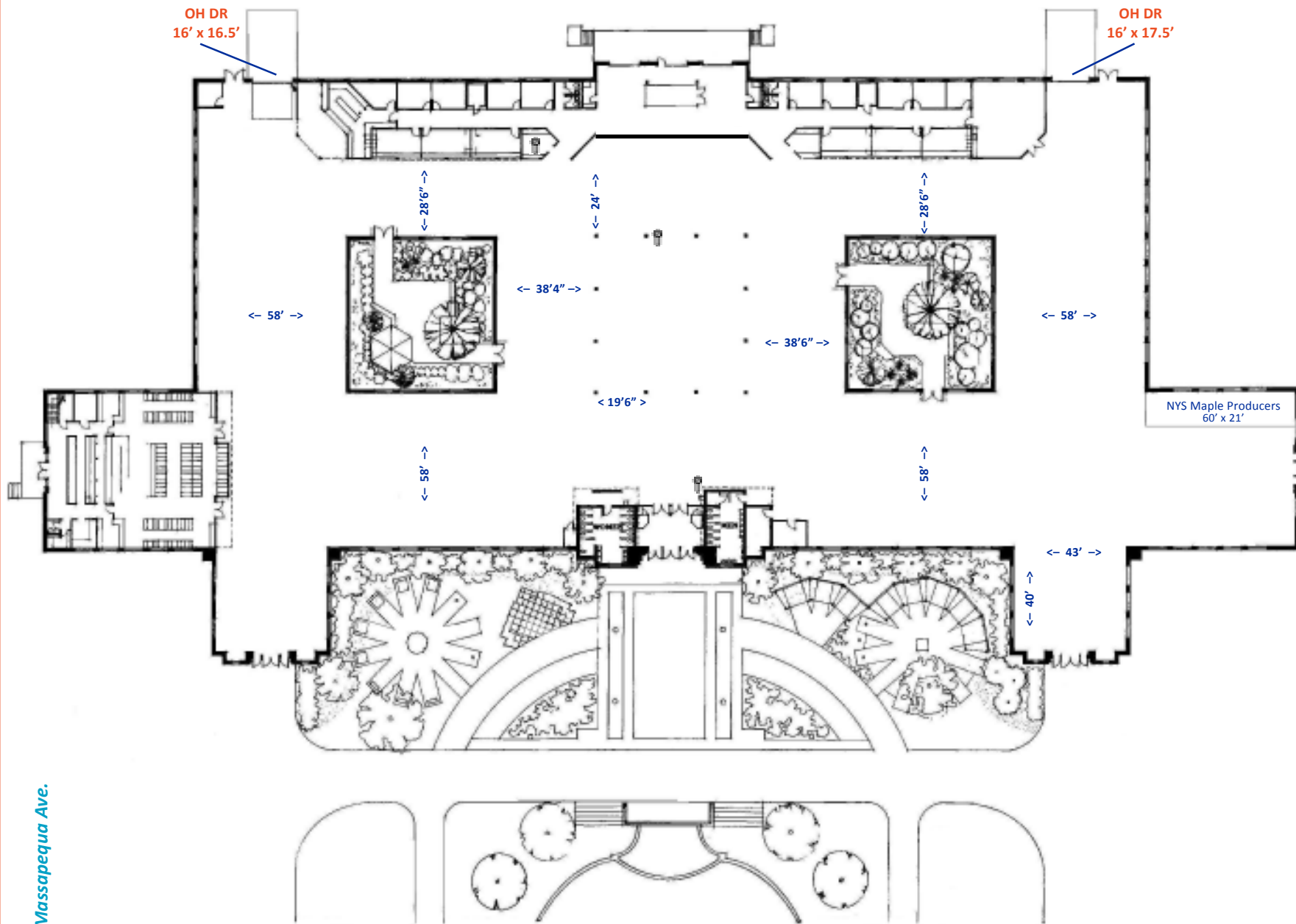

Massapequa Ave.

Hiawatha Ave.

# INTERNATIONAL BUILDING

• 16,000 Square Feet of Exhibit Space •

## FEATURES:

- Show Offices with phone line  
– 315.487.7711 x1284 (local calls only)
- Multiple Restaurants
- Seating for 774
  - 284 – Raised Bar Area seating
  - 196 – Raised Deck seating
  - 294 – General Picnic Table seating
- Restrooms
- Handicapped Accessibility

## ACCESS:

- 1 Overhead Door – 16' x 16.5'

## ELECTRICAL:

- Non-Commercial Electric

## LIGHTING/STAGING:

- 400W High Output Lighting Fixtures

## FLOORING:

- Concrete

## AUDIO:

- House Paging System
- Permanent Microphone Locations

■ = PILLARS

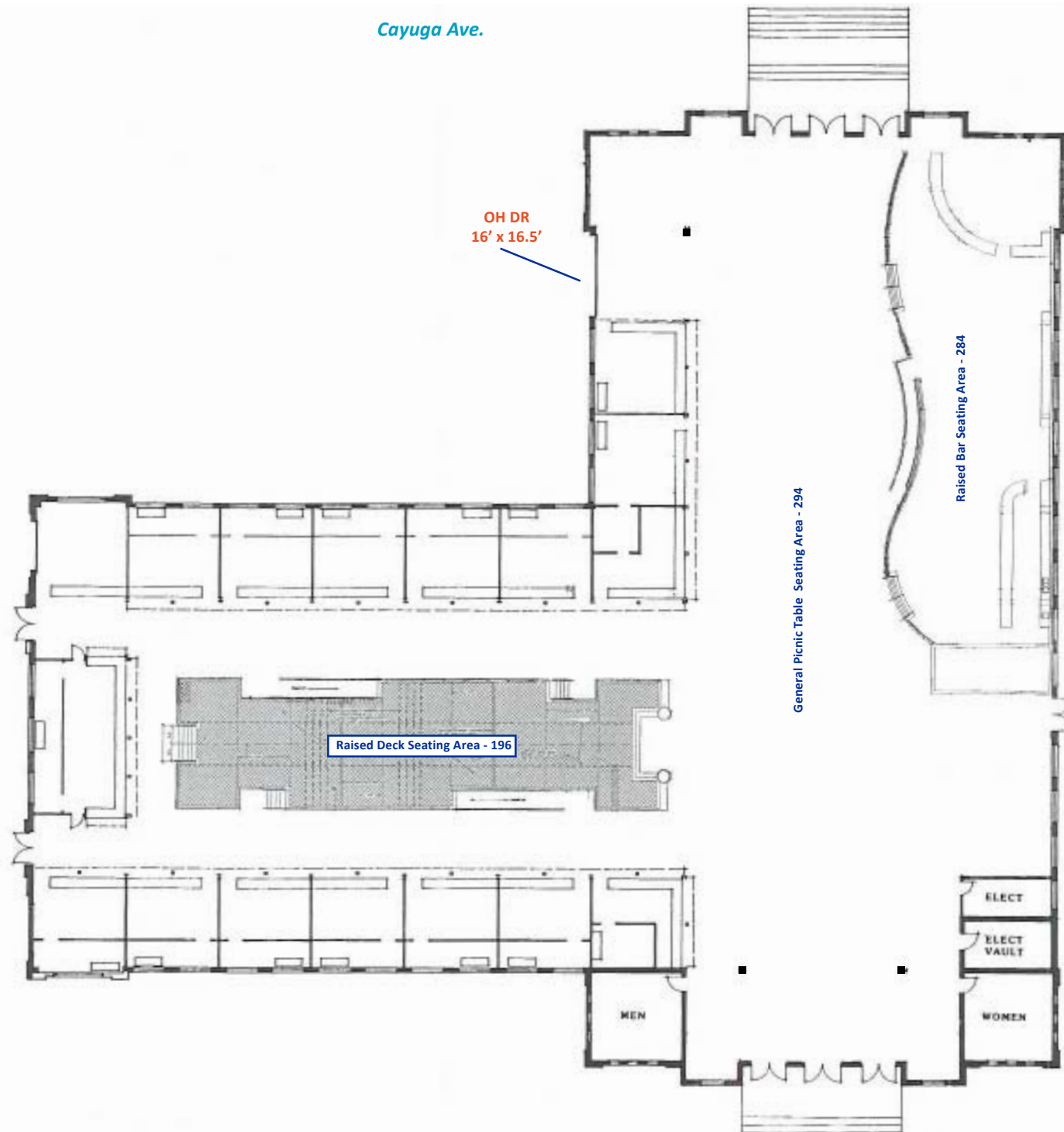



# MAIN HORSE BARN

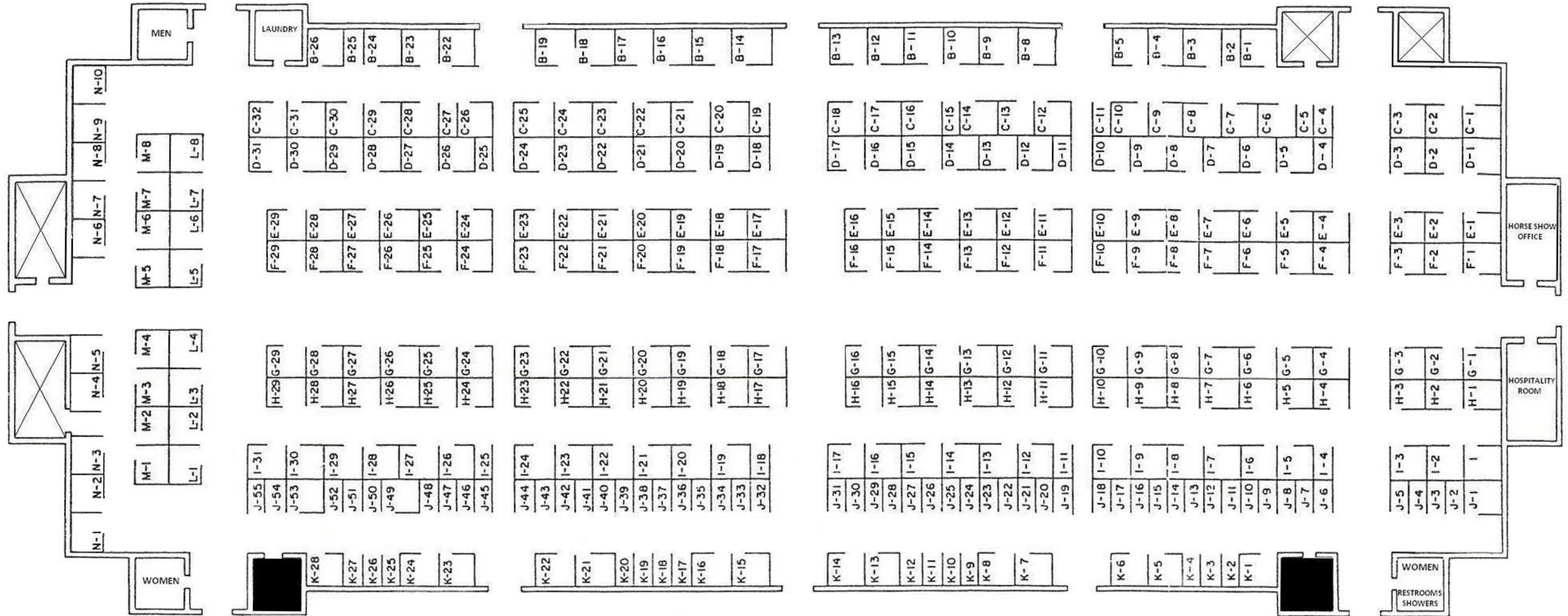

**BOX STALLS - 259**  
**TIE STALLS - 82**



# EMPIRE RV PARK

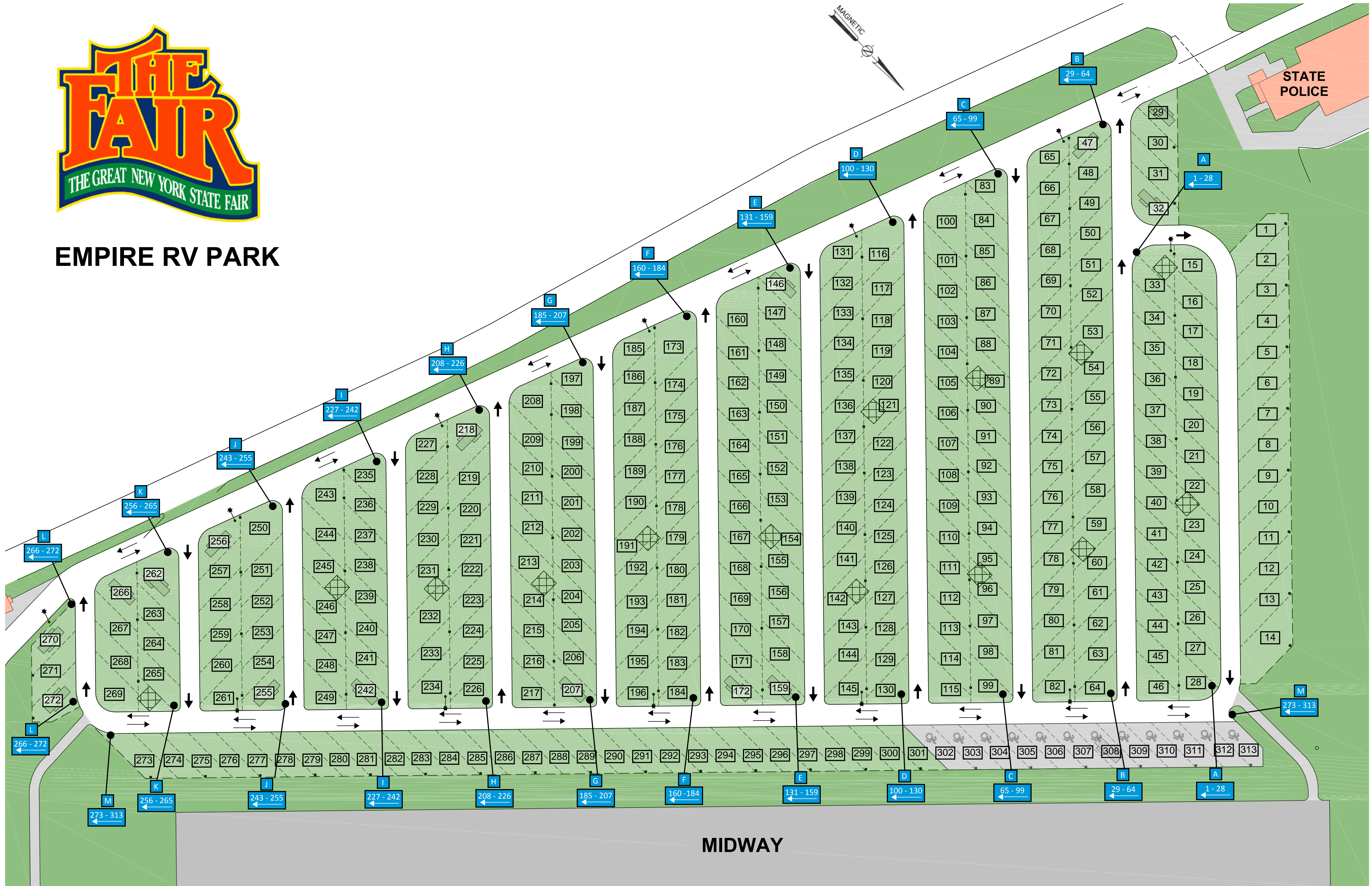

# STATE FAIR BOULEVARD

TONAWANDA STREET

DAIRY CATTLE BARN

HIAWATHA AVENUE

ONONDAGA AVENUE

EMPIRE COURT CENTER OF PROGRESS

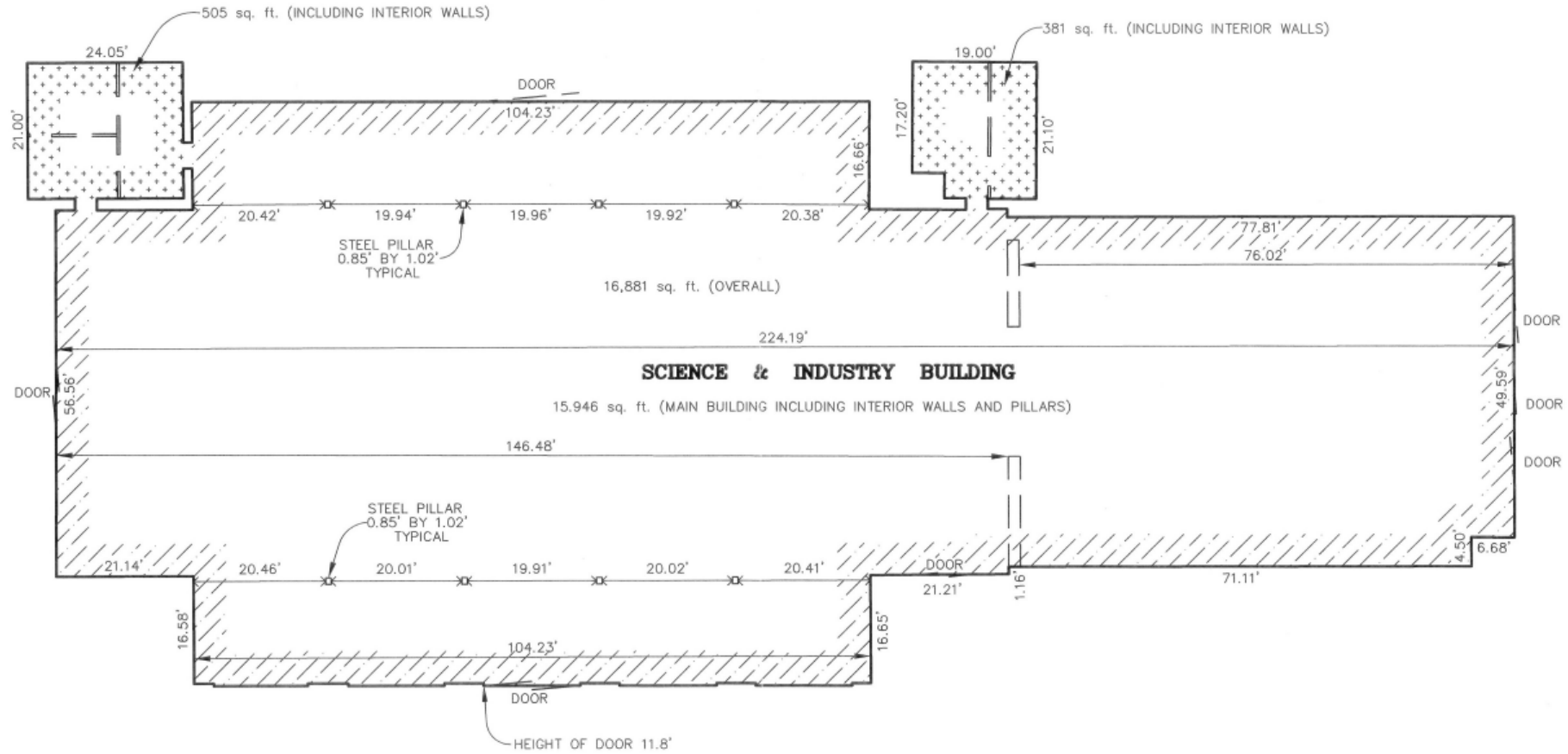

SKETCH PLAN OF THE INSIDE OF THE SCIENCE AND INDUSTRIAL BUILDING AT THE NEW YORK STATE FAIR GROUNDS		
DATE: 13 MARCH 2014	SCALE: 1"=20'	DRAWN BY: WJH
REVISIONS:		DRAWING No. 14-C-03 *B*